

Standard Series FP832A 8V3.2Ah

FirstPower®

Dimension(mm)

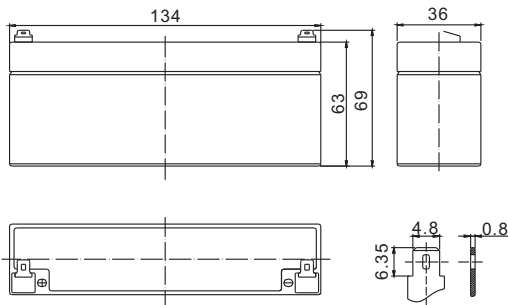

T1
Terminal



Specification

Nominal Voltage		8 V
Capacity(20HR, 25°C)		3.2 Ah
Dimension	Length	134mm (5.28inch)
	Width	36mm (1.42inch)
	Height	63mm (2.48inch)
	Total Height	69mm (2.72inch)
Approx. Weight		0.90kg (1.98lbs)

Characteristics

Capacity 20°C (68□) To 1.70V/Cell	20 hour rate	3.2Ah
	10 hour rate	3.0Ah
	5 hour rate	2.7Ah
	1 hour rate	2.06Ah
	15 min rate	1.46Ah
Internal resistance(Fully charged, 25°C)		Approx. 33m Ω
Capacity affected by temperature (20HR)	40°C	102%
	25°C	100%
	0°C	85%
	-15°C	65%
Self-discharge (25°C)	3 month	Remaining Capacity: 91%
	6 month	Remaining Capacity: 82%
	12 month	Remaining Capacity: 65%
Nominal operating temperature		25°C ±3°C(77°F ±5°F)
Operating temperature range		-15°C~50°C(5°F~122°F)
Float charging voltage(25°C)		9.00 to 9.20V
Cyclic charging voltage(25°C)		9.70 to 9.90V
Maximum charging current		0.96A
Terminal material		Copper
Maximum discharge current		48A(5 Sec.)

The Relationship for Open Circuit Voltage and Residual Capacity (25°C)

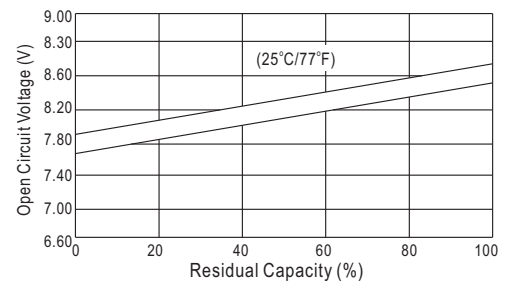

Charging Characteristics(25°C)

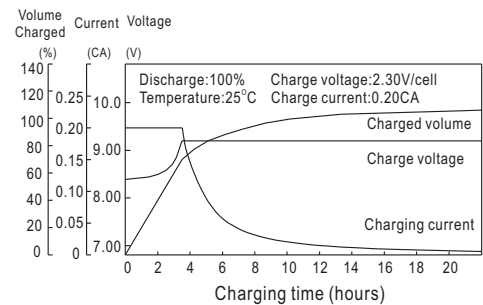

Cycle Life(25°C)

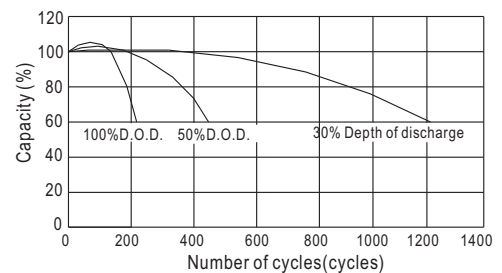

Constant Current Discharge Characteristics (A, 25°C)

F.V/TIME	5min	10min	15min	30min	60min	3h	5h	10h	20h
6.40V	12.0	7.70	6.10	3.70	2.15	0.81	0.55	0.30	0.16
6.80V	11.4	7.32	5.86	3.55	2.06	0.80	0.54	0.30	0.16
7.20V	10.7	6.88	5.56	3.37	1.96	0.78	0.53	0.30	0.16

Constant Power Discharge Characteristics (Watt, 25°C)

5min	10min	15min	30min	60min	3h	5h	10h	20h
89.3	57.9	46.4	28.3	16.6	6.43	4.36	2.44	1.30
84.8	55.0	44.5	27.1	15.9	6.34	4.30	2.41	1.29
79.7	51.7	42.3	25.8	15.1	6.21	4.21	2.41	1.28