

Standard Series FP250 2V5.0Ah

FirstPower®

Dimension

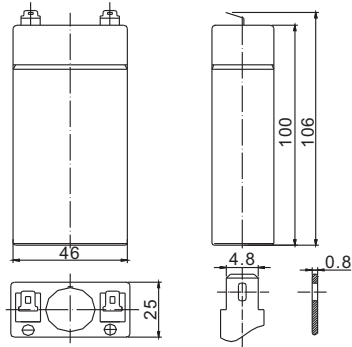

T1
Terminal



Specification

Nominal Voltage		2 V
Capacity(20HR, 25°C)		5 Ah
Dimension	Length	46mm (1.81inch)
	Width	25mm (0.98inch)
	Height	100mm (3.94inch)
	Total Height	106mm (4.17inch)
Approx. Weight		0.30kg (0.66lbs)

Characteristics

Capacity 20°C (68°F) To 1.70V/Cell	20 hour rate	5Ah
	10 hour rate	4.6Ah
	5 hour rate	4.15Ah
	1 hour rate	2.98Ah
	15 min rate	2.16Ah
Internal resistance(Fully charged, 25°C)		Approx. 8mΩ
Capacity affected by temperature (20HR)	40°C	102%
	25°C	100%
	0°C	85%
	-15°C	65%
Self-discharge (25°C)	3 month	Remaining Capacity: 91%
	6 month	Remaining Capacity: 82%
	12 month	Remaining Capacity: 65%
Nominal operating temperature		25°C ±3°C (77°F ±5°F)
Operating temperature range		-15°C~50°C (5°F~122°F)
Float charging voltage(25°C)		2.27 to 2.30V
Cyclic charging voltage(25°C)		2.42 to 2.48V
Maximum charging current		1.5A
Terminal material		Copper
Maximum discharge current		75A(5 secretary.)

The Relationship for Open Circuit Voltage and Residual Capacity (25°C)

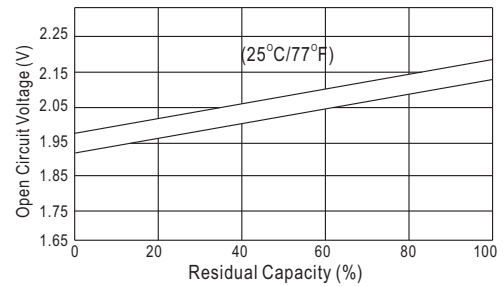

Charging Characteristics(25°C)

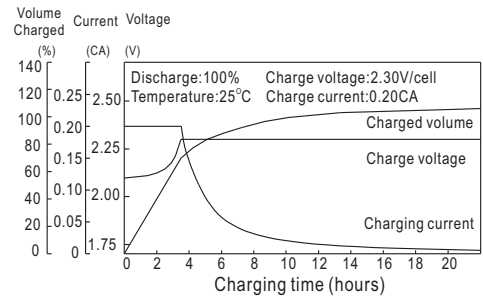

Cycle Life(25°C)

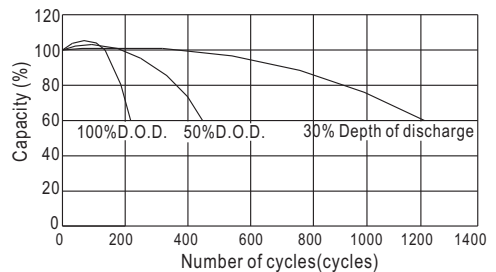

Constant Current Discharge Characteristics (A, 25°C)

F.V/TIME	5min	10min	15min	30min	60min	3h	5h	10h	20h
1.60V	18.5	11.5	9.00	5.40	3.10	1.19	0.84	0.46	0.25
1.70V	17.6	10.9	8.64	5.18	2.98	1.18	0.83	0.46	0.25
1.80V	16.5	10.3	8.21	4.92	2.83	1.15	0.81	0.46	0.25

Constant Power Discharge Characteristics (Watt, 25°C)

	5min	10min	15min	30min	60min	3h	5h	10h	20h
	34.4	21.6	17.1	10.3	5.98	2.36	1.67	0.92	0.51
	32.7	20.5	16.4	9.90	5.74	2.33	1.64	0.92	0.50
	30.7	19.3	15.6	9.41	5.46	2.28	1.61	0.92	0.50