

**Specifications**

Nominal Voltage		12 V
Capacity (25°C)	20HR(10.5V)	7Ah
	10HR(10.5V)	6.6Ah
	1HR(9.60V)	4.58Ah
Dimension	Length	151 ± 1.5mm (5.94inch)
	Width	65 ± 1mm (2.56inch)
	Height	94 ± 1mm (3.70inch)
	Total Height	100 ± 1mm (3.94inch)
Approx. Weight		2.35kg (5.18lbs) ± 5%
Terminal type		T1/T2
Internal resistance (Fully charged, 25°C)		Approx. 28mΩ
Capacity affected by temperature (20HR)	40°C	102%
	25°C	100%
	0°C	85%
	-15°C	65%
Self-discharge (25°C)	3 month	Remaining Capacity: 91%
	6 month	Remaining Capacity: 82%
	12 month	Remaining Capacity: 65%
Nominal operating temperature		25°C ± 3°C (77°F ± 5°F)
Operating temperature range	Discharge	-15°C ~ 70°C (5°F ~ 158°F)
	Charge	-10°C ~ 70°C (14°F ~ 158°F)
	Storage	-20°C ~ 70°C (-4°F ~ 158°F)
Float charging voltage(25°C)		13.60 to 13.80V Temperature compensation: -18mV/°C
Cyclic charging voltage(25°C)		14.50 to 14.90V Temperature compensation: -30mV/°C
Maximum charging current		2.1A
Terminal material		Copper
Maximum discharge current		105A(5 sec.)
Designed floating life(20°C)		5~7 years

- ◆ Absorbent glass mat technology;
- ◆ Recognized by UL & CE;
- ◆ ABS container.

**Constant Current Discharge Characteristics (A, 25°C)**

F.V/TIME	5min	10min	15min	30min	60min	2h	3h	4h	5h	10h	20h
9.60V	26.2	16.5	13.2	7.38	4.58	2.50	1.80	1.44	1.22	0.67	0.36
9.90V	25.4	16.0	12.9	7.23	4.51	2.49	1.79	1.43	1.22	0.66	0.36
10.2V	24.3	15.4	12.4	7.01	4.40	2.47	1.77	1.42	1.21	0.66	0.35
10.5V	23.3	14.7	12.0	6.84	4.31	2.43	1.76	1.41	1.20	0.66	0.35
10.8V	22.0	13.9	11.4	6.59	4.18	2.37	1.71	1.37	1.16	0.64	0.35

**Constant Power Discharge Characteristics (Watt, 25°C)**

F.V/TIME	5min	10min	15min	30min	60min	2h	3h	4h	5h	10h	20h
9.60V	292	186	151	84.5	53.1	29.3	21.4	17.1	14.6	7.99	4.29
9.90V	283	181	147	82.8	52.3	29.1	21.2	17.0	14.5	7.95	4.28
10.2V	272	173	142	80.3	50.9	28.9	21.1	16.9	14.4	7.92	4.26
10.5V	260	166	137	78.4	49.9	28.4	20.9	16.8	14.3	7.87	4.23
10.8V	245	157	130	75.5	48.4	27.7	20.3	16.3	13.9	7.71	4.15

Note: The above characteristics data can be obtained within three charge/discharge cycles.

**Dimensions**

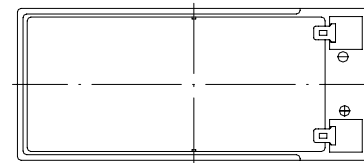
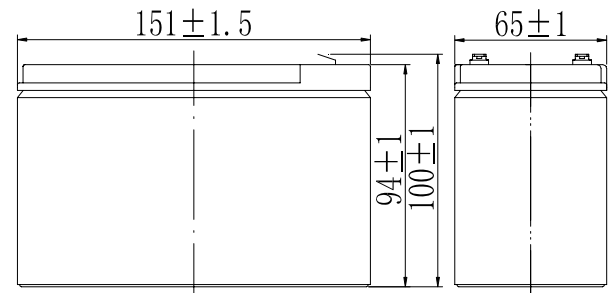

**Terminal**

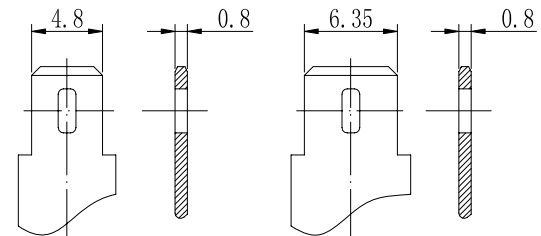

Terminal T1

Terminal T2

**Discharge Characteristics(25°C)**

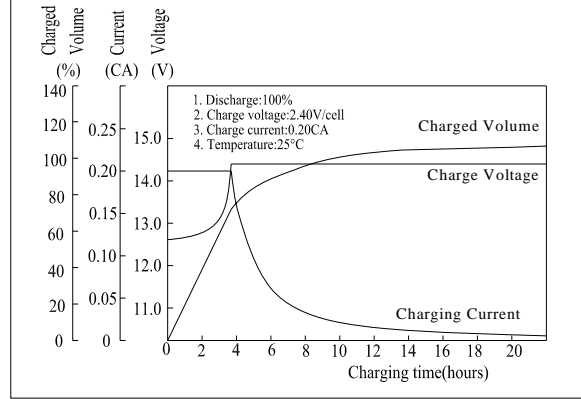
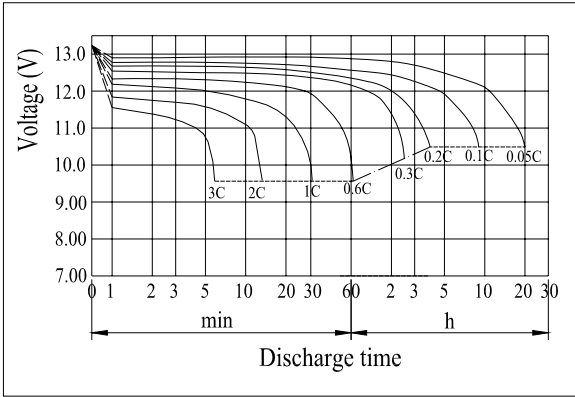

**Effect of Temperature on Capacity**

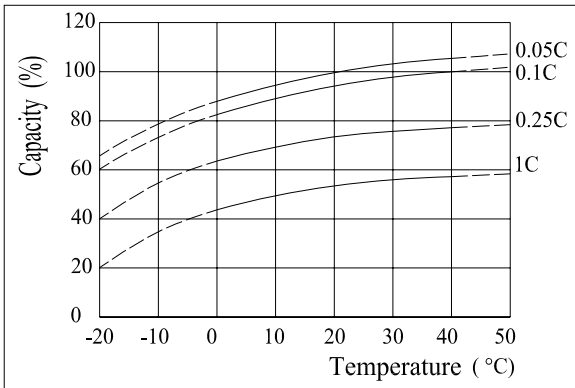

**Self-discharge Characteristics**

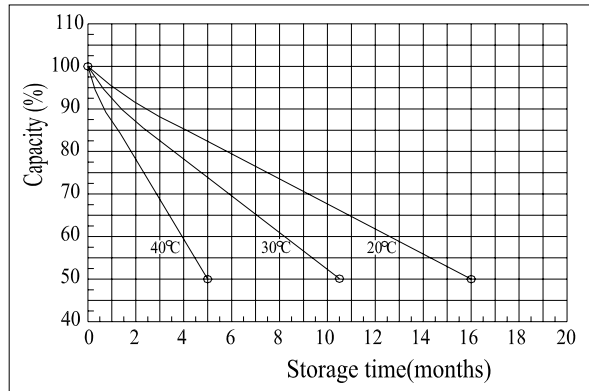

**The Relationship for Open Circuit Voltage and Residual Capacity (25°C)**

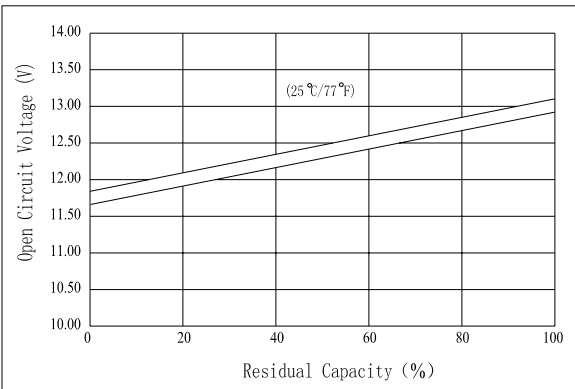

**The Relationship for Charging Voltage and Temperature**



**Floating Life on Temperature**

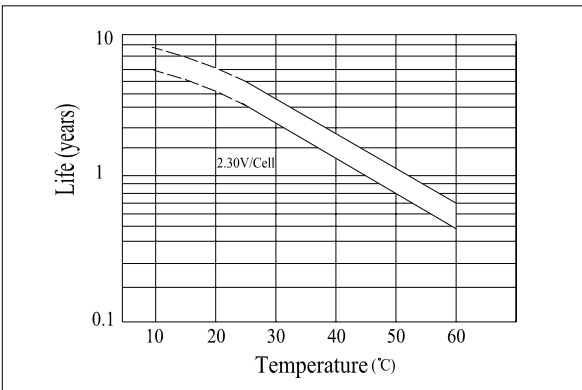

**Cycle Life on D.O.D(25°C)**

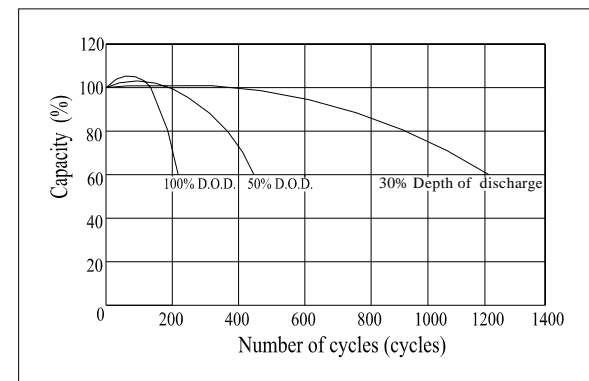

**Charging Characteristics(25°C)**