

Specifications

| | | |
|---|--------------|---|
| Nominal Voltage | | 12 V |
| Capacity (25°C) | 20HR(10.5V) | 2.6Ah |
| | 10HR(10.5V) | 2.3Ah |
| | 1HR(9.60V) | 1.63Ah |
| Dimension | Length | 70 ± 1mm (2.76inch) |
| | Width | 48 ± 1mm (1.89inch) |
| | Height | 98 ± 1mm (3.86inch) |
| | Total Height | 104 ± 1mm (4.09inch) |
| Approx. Weight | | 0.85kg (1.87lbs) ± 5% |
| Terminal type | | T1 |
| Internal resistance (Fully charged, 25°C) | | Approx. 55mΩ |
| Capacity affected by temperature (20HR) | 40°C | 102% |
| | 25°C | 100% |
| | 0°C | 85% |
| | -15°C | 65% |
| Self-discharge (25°C) | 3 month | Remaining Capacity: 91% |
| | 6 month | Remaining Capacity: 82% |
| | 12 month | Remaining Capacity: 65% |
| Nominal operating temperature | | 25°C ± 3°C (77°F ± 5°F) |
| Operating temperature range | Discharge | -15°C ~ 50°C (5°F ~ 122°F) |
| | Charge | -10°C ~ 50°C (14°F ~ 122°F) |
| | Storage | -20°C ~ 50°C (-4°F ~ 122°F) |
| Float charging voltage(25°C) | | 13.60 to 13.80V Temperature compensation: -18mV/°C |
| Cyclic charging voltage(25°C) | | 14.50 to 14.90V Temperature compensation: -30mV/°C |
| Maximum charging current | | 0.78A |
| Terminal material | | Copper |
| Maximum discharge current | | 39A(5 sec.) |
| Designed floating life(20°C) | | 3~5 years |

- ◆ Absorbent glass mat technology;
- ◆ Recognized by UL & CE;
- ◆ ABS container.

Constant Current Discharge Characteristics (A, 25°C)

| F.V/TIME | 5min | 10min | 15min | 30min | 60min | 2h | 3h | 4h | 5h | 10h | 20h |
|----------|------|-------|-------|-------|-------|------|------|------|------|------|------|
| 9.60V | 9.50 | 6.00 | 4.75 | 2.65 | 1.63 | 0.89 | 0.64 | 0.51 | 0.43 | 0.24 | 0.13 |
| 9.90V | 9.22 | 5.82 | 4.64 | 2.60 | 1.60 | 0.88 | 0.63 | 0.51 | 0.43 | 0.24 | 0.13 |
| 10.2V | 8.84 | 5.58 | 4.47 | 2.52 | 1.56 | 0.88 | 0.63 | 0.50 | 0.43 | 0.23 | 0.13 |
| 10.5V | 8.46 | 5.34 | 4.31 | 2.46 | 1.53 | 0.86 | 0.63 | 0.50 | 0.43 | 0.23 | 0.13 |
| 10.8V | 7.98 | 5.04 | 4.09 | 2.37 | 1.48 | 0.84 | 0.61 | 0.49 | 0.41 | 0.23 | 0.12 |

Constant Power Discharge Characteristics (Watt, 25°C)

| F.V/TIME | 5min | 10min | 15min | 30min | 60min | 2h | 3h | 4h | 5h | 10h | 20h |
|----------|------|-------|-------|-------|-------|------|------|------|------|------|------|
| 9.60V | 106 | 67.7 | 54.2 | 30.4 | 18.8 | 10.4 | 7.57 | 6.07 | 5.18 | 2.83 | 1.52 |
| 9.90V | 103 | 65.6 | 52.9 | 29.8 | 18.5 | 10.3 | 7.53 | 6.04 | 5.15 | 2.82 | 1.52 |
| 10.2V | 98.6 | 62.9 | 50.9 | 28.9 | 18.1 | 10.2 | 7.48 | 6.00 | 5.11 | 2.81 | 1.51 |
| 10.5V | 94.4 | 60.2 | 49.2 | 28.2 | 17.7 | 10.1 | 7.43 | 5.96 | 5.07 | 2.79 | 1.50 |
| 10.8V | 89.1 | 56.9 | 46.6 | 27.1 | 17.2 | 9.83 | 7.20 | 5.78 | 4.92 | 2.73 | 1.47 |

Note: The above characteristics data can be obtained within three charge/discharge cycles.

Dimensions

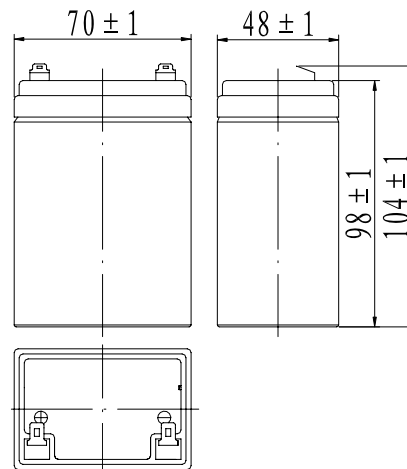

Terminal

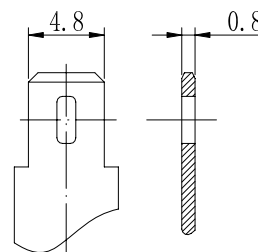

Terminal T1

Discharge Characteristics(25°C)

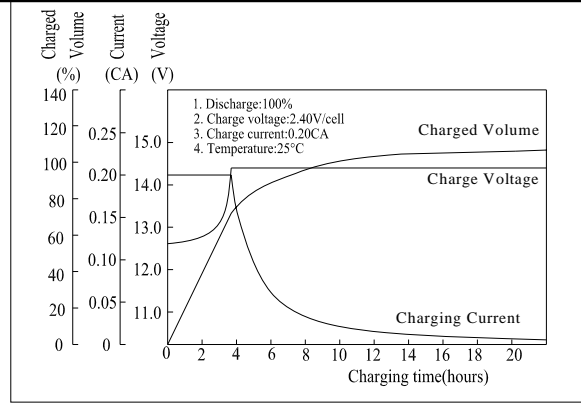
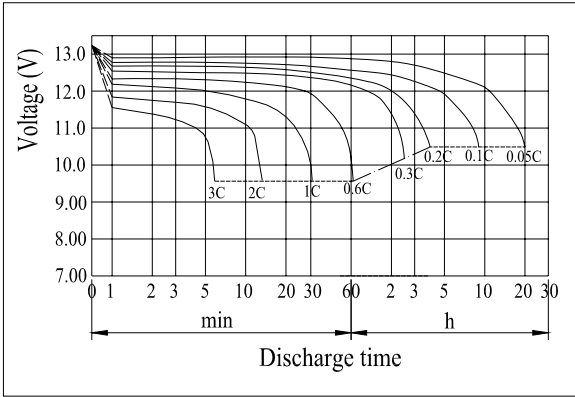

Effect of Temperature on Capacity

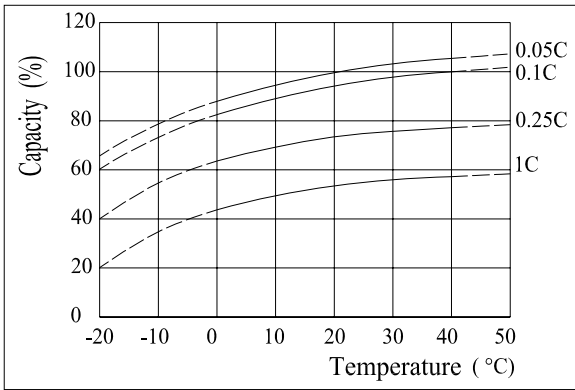

Self-discharge Characteristics

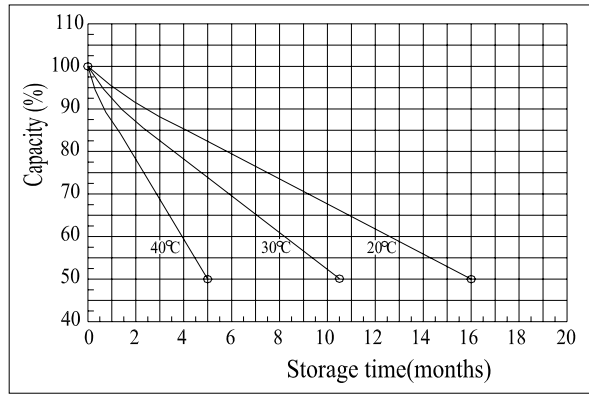

The Relationship for Open Circuit Voltage and Residual Capacity (25°C)

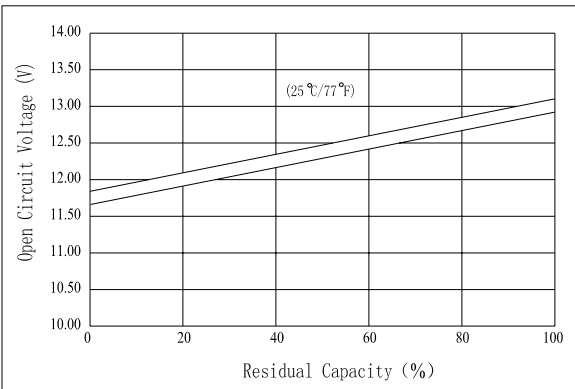

The Relationship for Charging Voltage and Temperature

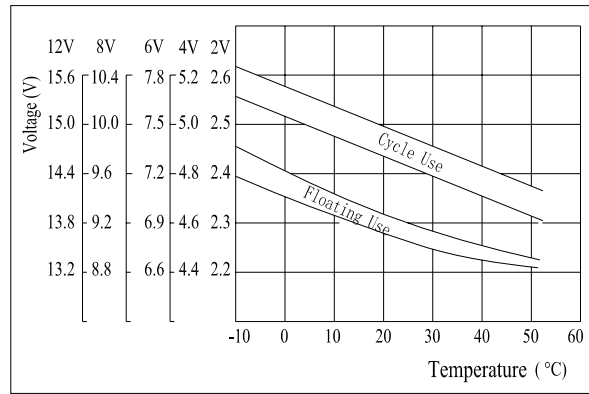

Floating Life on Temperature

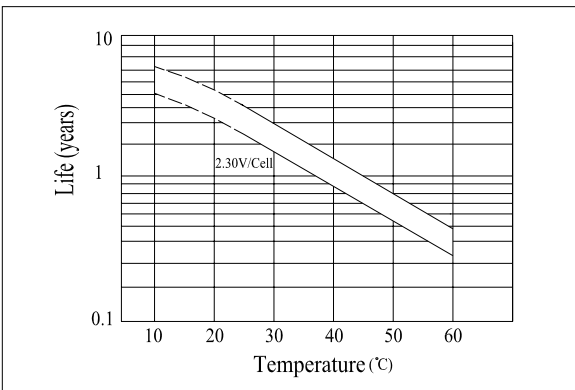

Cycle Life on D.O.D(25°C)

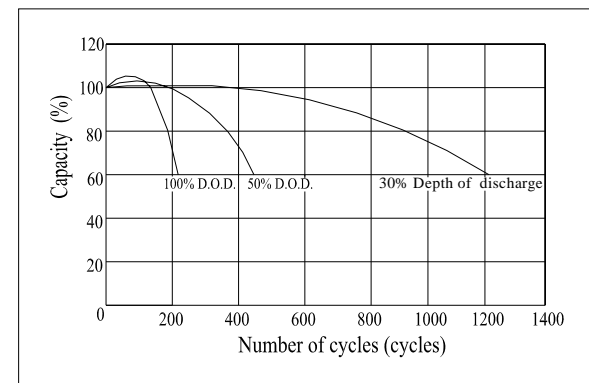

Charging Characteristics(25°C)